

PIN GAUGE SETS WITH HANDLE

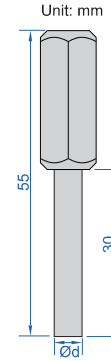

4266-5

- Meet DIN2269, grade 1
- Made of alloy steel
- Hardness HRC62-65
- Diameter accuracy: $\pm 1\mu\text{m}$



Code	Diameter Ød (mm)	Step	Pin gauges per set
4266-411	1.0, 1.1, 1.2, 5.0	0.1mm	41
4266-511	5.0, 5.1, 5.2, 10.0	0.1mm	51
4266-512	10.0, 10.1, 10.2, 15.0	0.1mm	51
4266-513	15.0, 15.1, 15.2, 20.0	0.1mm	51

Code	Diameter Ød (mm)	Step	Pin gauges per set
4266-2S	1.00, 1.01, 1.02, 2.00	0.01mm	101
4266-3S	2.00, 2.01, 2.02, 3.00	0.01mm	101
4266-4S	3.00, 3.01, 3.02, 4.00	0.01mm	101
4266-5S	4.00, 4.01, 4.02, 5.00	0.01mm	101
4266-6S	5.00, 5.01, 5.02, 6.00	0.01mm	101
4266-7S	6.00, 6.01, 6.02, 7.00	0.01mm	101
4266-8S	7.00, 7.01, 7.02, 8.00	0.01mm	101
4266-9S	8.00, 8.01, 8.02, 9.00	0.01mm	101
4266-10S	9.00, 9.01, 9.02, 10.00	0.01mm	101

Code	Diameter Ød (mm)	Step	Pin gauges per set
4266-1D	1.00, 1.01, 1.02, 1.50	0.01mm	51
4266-2	1.50, 1.51, 1.52, 2.00	0.01mm	51
4266-2D	2.00, 2.01, 2.02, 2.50	0.01mm	51
4266-3	2.50, 2.51, 2.52, 3.00	0.01mm	51
4266-3D	3.00, 3.01, 3.02, 3.50	0.01mm	51
4266-4	3.50, 3.51, 3.52, 4.00	0.01mm	51
4266-4D	4.00, 4.01, 4.02, 4.50	0.01mm	51
4266-5	4.50, 4.51, 4.52, 5.00	0.01mm	51
4266-5D	5.00, 5.01, 5.02, 5.50	0.01mm	51
4266-6	5.50, 5.51, 5.52, 6.00	0.01mm	51
4266-6D	6.00, 6.01, 6.02, 6.50	0.01mm	51
4266-7	6.50, 6.51, 6.52, 7.00	0.01mm	51
4266-7D	7.00, 7.01, 7.02, 7.50	0.01mm	51
4266-8	7.50, 7.51, 7.52, 8.00	0.01mm	51
4266-8D	8.00, 8.01, 8.02, 8.50	0.01mm	51
4266-9	8.50, 8.51, 8.52, 9.00	0.01mm	51
4266-9D	9.00, 9.01, 9.02, 9.50	0.01mm	51
4266-10	9.50, 9.51, 9.52, 10.00	0.01mm	51
4266-10D	10.00, 10.01, 10.02, 10.50	0.01mm	51

Code	Diameter Ød (mm)	Step	Pin gauges per set
4266-11	10.50, 10.51, 10.52, 11.00	0.01mm	51
4266-11D	11.00, 11.01, 11.02, 11.50	0.01mm	51
4266-12	11.50, 11.51, 11.52, 12.00	0.01mm	51
4266-12D	12.00, 12.01, 12.02, 12.50	0.01mm	51
4266-13	12.50, 12.51, 12.52, 13.00	0.01mm	51
4266-13D	13.00, 13.01, 13.02, 13.50	0.01mm	51
4266-14	13.50, 13.51, 13.52, 14.00	0.01mm	51
4266-14D	14.00, 14.01, 14.02, 14.50	0.01mm	51
4266-15	14.50, 14.51, 14.52, 15.00	0.01mm	51
4266-15D	15.00, 15.01, 15.02, 15.50	0.01mm	51
4266-16	15.50, 15.51, 15.52, 16.00	0.01mm	51
4266-16D	16.00, 16.01, 16.02, 16.50	0.01mm	51
4266-17	16.50, 16.51, 16.52, 17.00	0.01mm	51
4266-17D	17.00, 17.01, 17.02, 17.50	0.01mm	51
4266-18	17.50, 17.51, 17.52, 18.00	0.01mm	51
4266-18D	18.00, 18.01, 18.02, 18.50	0.01mm	51
4266-19	18.50, 18.51, 18.52, 19.00	0.01mm	51
4266-19D	19.00, 19.01, 19.02, 19.50	0.01mm	51
4266-20	19.50, 19.51, 19.52, 20.00	0.01mm	51